

LINEAR GUIDEWAYS
BED TYPE MILLING
MACHINES

RT

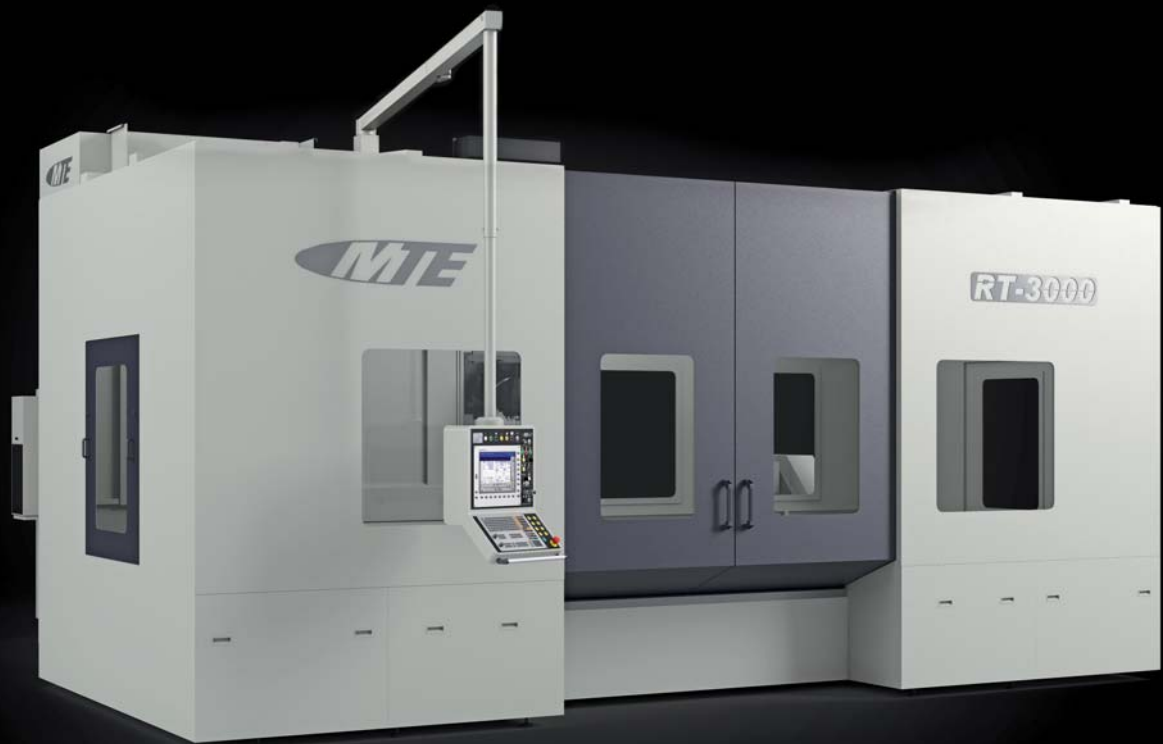

The **RT bed type** milling machine unites all the advantages of a traditional table type boring mill with those of a milling machine.

The combination of a highly stable built-in NC rotary table with an automatically swivelling milling head makes it possible, in addition to regular drill centre machining operations, to make complex workpieces with five sides and all conceivable angle positions in a single set-up with up to 5 processing axes.

TECHNICAL FEATURES

		RT	2000	2500	3000
TABLE					
Working surface	mm	1.050 x 1.050 / 1.500 x 1.250 / 1.600 x 1.400			
T-slots	mm	1x22H7 + 6x22H12 in 125			
Maximum load	kg	8.000 - 15.000			
TRAVELS					
X axis (longitudinal)	mm	2.000		2.500	3.000
Y axis (cross)	mm	1.200 (1.500) ¹			
Z axis (vertical)	mm	1.500 (2.000) ¹			
SPINDLE					
Spindle taper		SK50 DIN 69871 / AD			
Speed	rpm	4000 / (6.000) ¹			
Ranges		3			
Power	kW	32 ² (40) ¹			
Maximum torque	Nm	2.050 ³ (4.000 rpm) 1.085 ⁴ (6.000 rpm) ¹			
FEEDS					
Maximum feed	m/min	25			
WEIGHT					
Machine weight	kg	25.000		28.000	30.000

¹ option.

² Heidenhain motor.

³ Heidenhain 32 kW and AFK milling head. For further information (combination of other milling heads and power), please feel free to contact us.

⁴ option. Heidenhain 32 kW and AFK milling head. For further information (combination of other milling heads and power), please feel free to contact us.



RT Open Top model. Side view



RT Open Top model. Backside view

OPEN TOP ENCLOSURE RT (Y1200)

DIMENSIONS

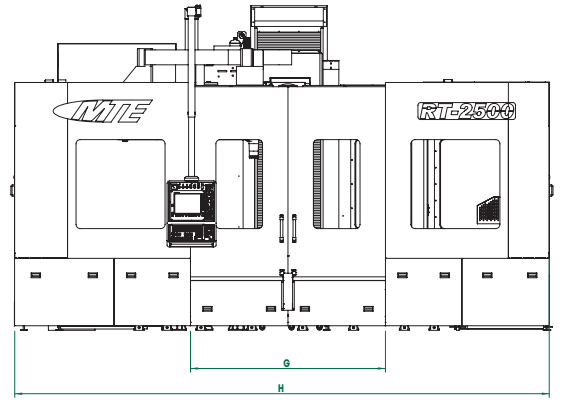
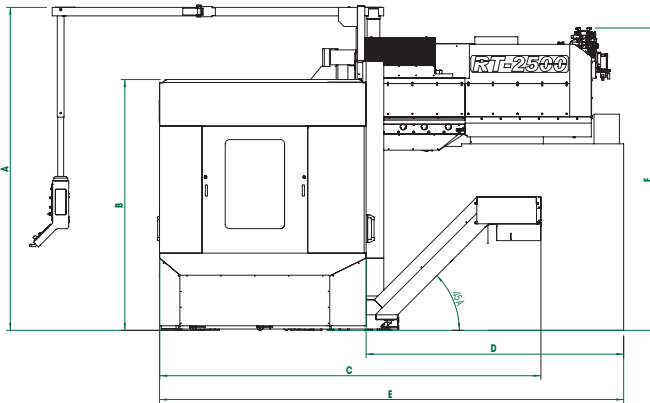

RT (Y1200) OPEN TOP ENCLOSURE (mm)

	A	B	C	D	E	F	G	H
RT-2000	3.850 ¹	2.925 ²	4.500	3.040	5.500	3.570 ³	2.300	5.350
RT-2500	3.850 ¹	2.925 ²	4.500	3.040	5.500	3.570 ³	2.300	6.350
RT-3000	3.850 ¹	2.925 ²	4.500	3.040	5.500	3.570 ³	2.600	7.000

Data for Z=1500.

¹ 4350 for Z= 2000.

² 3425 for Z= 2000; +500 with Full Closed enclosure.

³ 4070 for Z= 2000.



MILLING HEADS. RT Y1200

AUTOMATIC MILLING HEAD (AFK) 2,5°x2,5° (4.000/6.000 rpm) / 1x2,5° (4.000/6.000 rpm)

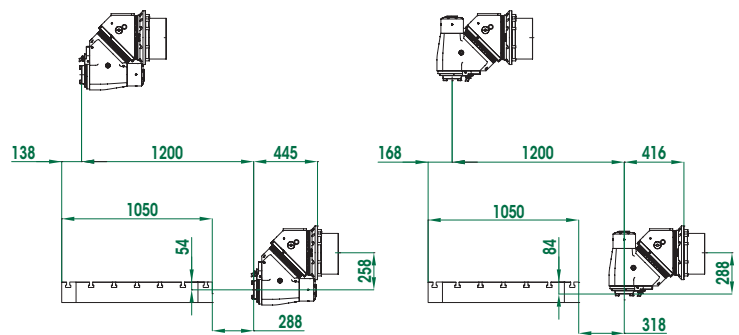

MANUAL MILLING HEAD 4.000/6.000 rpm (MFK)

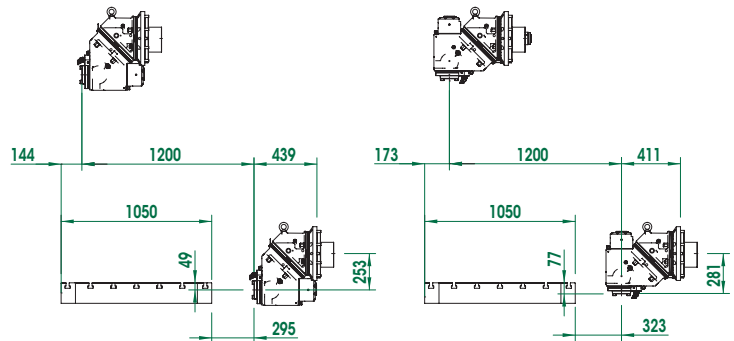

DIRECT SPINDLE HEAD 4.000 rpm (HFK-225)

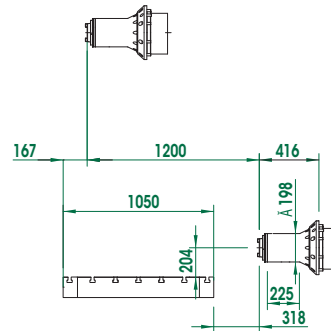

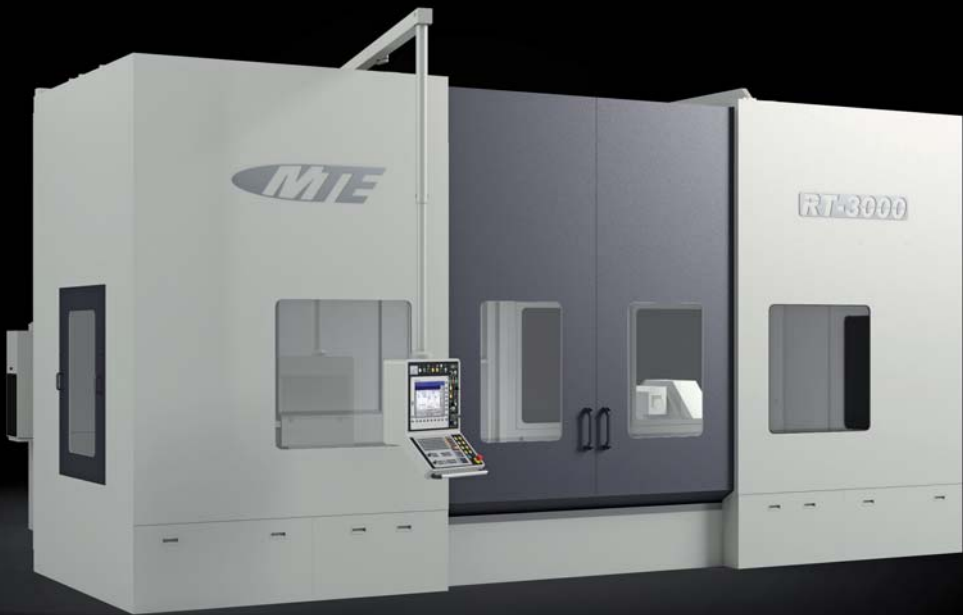
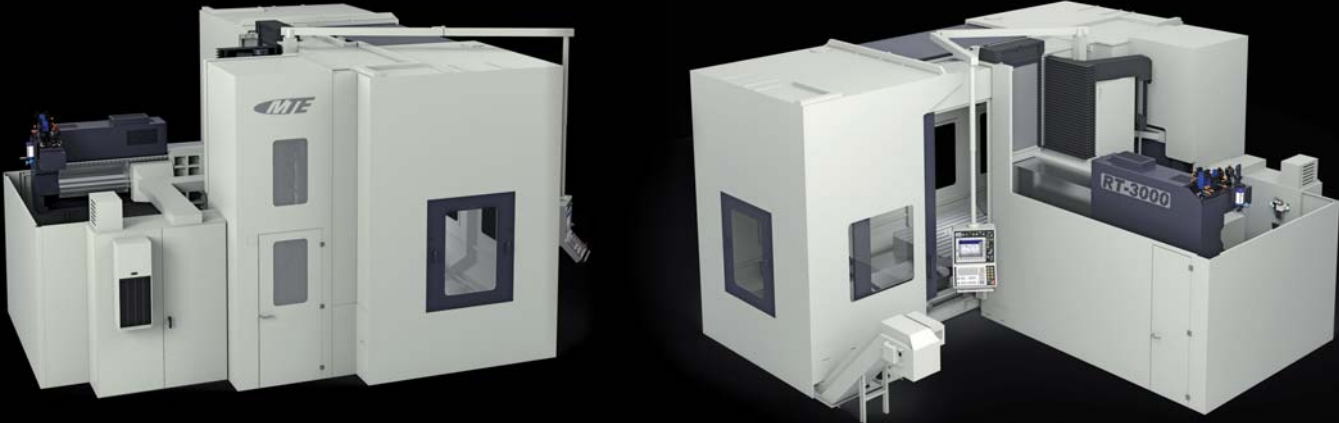

RT Closed Top model

> OPEN TOP ENCLOSURE RT (Y1500)

DIMENSIONS

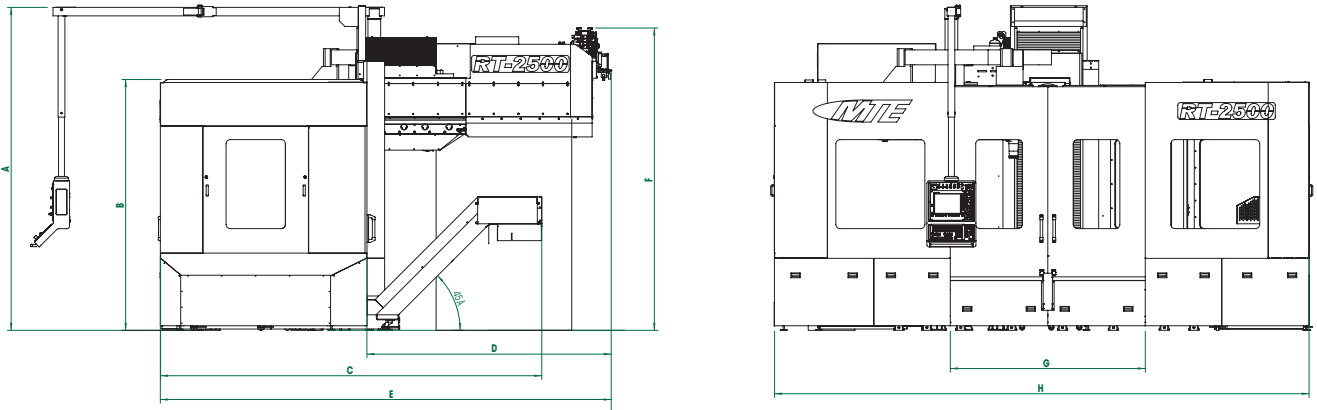

RT (Y1500) OPEN TOP ENCLOSURE (mm)

	A	B	C	D	E	F	G	H
RT-2000	3.800 ¹	2.925 ²	4.550	3.500	6.200 ³	3.650 ⁴	2.300	5.500
RT-2500	3.800 ¹	2.925 ²	4.550	3.500	6.200 ³	3.650 ⁴	2.300	6.500
RT-3000	3.800 ¹	2.925 ²	4.550	3.500	6.200 ³	3.650 ⁴	2.600	7.500

Data for Z=1500 and AFK milling head.

¹ 4300 for Z= 2000.

² 3425 for Z= 2000; +500 with Full Closed enclosure

³ 6500 with SFK head and 250 bed-column spacer.

⁴ 4150 for Z= 2000.



MILLING HEADS. RT Y1500

AUTOMATIC MILLING HEAD (AFK) 2,5°x2,5° (4.000/6.000 rpm) / 1x2,5° (4.000/6.000 rpm)

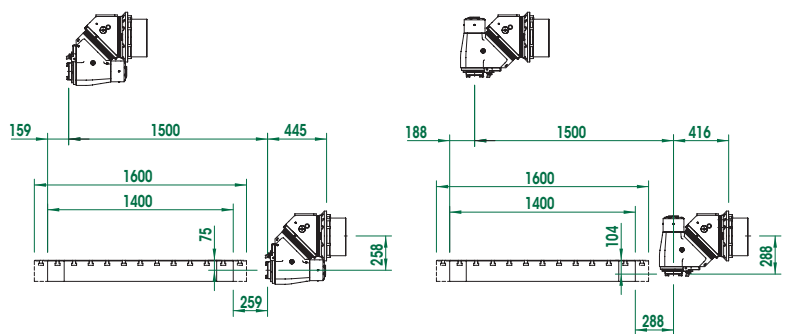

AUTOMATIC CONTINUOUS MILLING HEAD (SFK) / 0,001x0,001° (4.000/6.000 rpm)

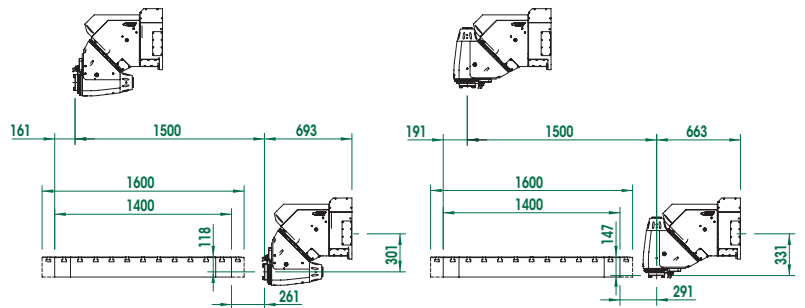

DIRECT SPINDLE HEAD 4.000 rpm (HFK-225)

